



Ships & Boats

Oil Services

SEA BULK PLOVER

Material Crain accommodation barge



SEA BULK PLOVER

MAIN PARTICULARS

Name: Sea Bulk Plover
 Class: BV / Deep Sea Barge
 GRT: 1538
 NRT: 461
 Flag: Republic of Sierra Leone
 P. OF Registry: Freetown

PRINCIPAL DIMENSIONS

Length O.A.: 70.10 m
 Breadth: 18.29
 Height: 4.26 m
 Draft: 1.8 m
 IMO NO: 8637421

GENERATORS:

1x60 KVA Caterpillar 3508
 1x90KVA Caterpillar 3512
 1x150 KVA Caterpillar 3926

PUMPS:

1x4 PSI Fuel Pump
 1x8 PSI Water Fire Pump
 2x4 PSI Sewage Pump

ADDITIONAL EQUIPMENT

1x Welding Workshop
 1x Maintenance & Repair workshop

CRANE

Type: Sany Crane
 Max Rated Load: 155 Tons
 Boam Length: 35 M
 Wire Work Length: 300 M





Ships & Boats

Oil Services

SEA BULK PLOVER

<p>MOORING SYSTEM</p> <p>(1)1x Samatco Double Drum 1000m wire (1)1x CAT Engine 3406 SR4 (2)1 x Samatco Double Drum 900m wire (2)1x GM Detroit 200BHP (3) 2 Double drum, diesel driven winches (3)1x GM Detroit 200BHP (4) 2 Double drum, diesel driven winches (4)1x GM Detroit (4) 2 Double drum, (4)1x GM Detroit Pulling forces for each Winch 2 x 136 tonnes (5) 1 x Single drum heaving 100 tonnes (5)Pulling forces for winch is 250 Tonnes Total Number winches is 9 winches Corner plus one for parking Each Winch 2 x 136 tonnes</p>	<p>ANCHORS SYSTEM</p> <p>(2)2 x 7.5 Tonnes Flipper Delta HHP Double Drum 700m wire, 32mm Solid Core (2)2 x 4 Tonnes Flipper Delta HHP Double Drum 900m wire 2"inch Solid Core (3)2 x 4 Tonnes Flipper Delta HHP Double Drum 800m wire 2"inch Solid Core for Brest Anchors (4)1 x 8 Tonnes Flipper Delta HHP Double Drum Parking Anchors for stern Anchors, 4 Anchors 2 at each corner for Bow Anchors, 4 Anchors 2 at each corner Parking Anchor, 1 Anchor mid stern mounting of tackles total pulling force stern can be adjusted to load max. 2x500 tons mounting of tackles total pulling force stern be adjusted to load max. 2x500 tons Fairleads: 8 Rover Fairleads</p>
<p>DECK CRANE</p> <p>Deck Cranes (2) 1x3 tons @ outreach 5m 1x5 tons @ outreach 7m</p>	<p>SEWAGE TREATMENT</p> <p>1x sewage treatment tank 80 person 1x sewage treatment Plant for 80 person</p>
<p>NAVIGATION & COMENECATIONS</p> <p>2 X DGPS TRIMBLE 4 X Portable VH Radio 1 x Magnetic Compass 2 x Internet wireless System 1 x Thorya Sat Phone System 1 x Radar 1x GSM Communication</p> <p>CAPACITIES</p> <p>FW 1200 Ton Fuel 600 Ton Ballast Water 1200 ton</p>	<p>ACCOMMODATION</p> <p>2 x 1 man single Cabin = 2 4 x 2 men double room cabin = 8 9 x 4 men room cabin = 36 Total Accommodations is 46 Personnel 2 Offices equipped 1 Galley + Recreation Room 1 x Sewage plant Crew is 8 personnel Passenger; 44 personnel Galley Seats= 20 men meals/chairs</p>



Ships & Boats

Oil Services



SEA BULK PLOVER

Head Office: 23 Fawzy Moaaz St., Horia Mall Floor 12, Alexandria, Egypt
Tel. / Fax: + (203) 4281085-9575180 E-Mail: info@Ships-boats.com
Branch Office: 27 North Choueifat Str., El-Tagamoa El-Khames. -New Cairo City, Egypt.
Tel: +(202) 261 755 70 Fax: +(202) 261 755 40 Mob :+(20100) 6933200
E-Mail: gomaa@ships-boats.com www.Ships-boats.com





Ships & Boats

Oil Services

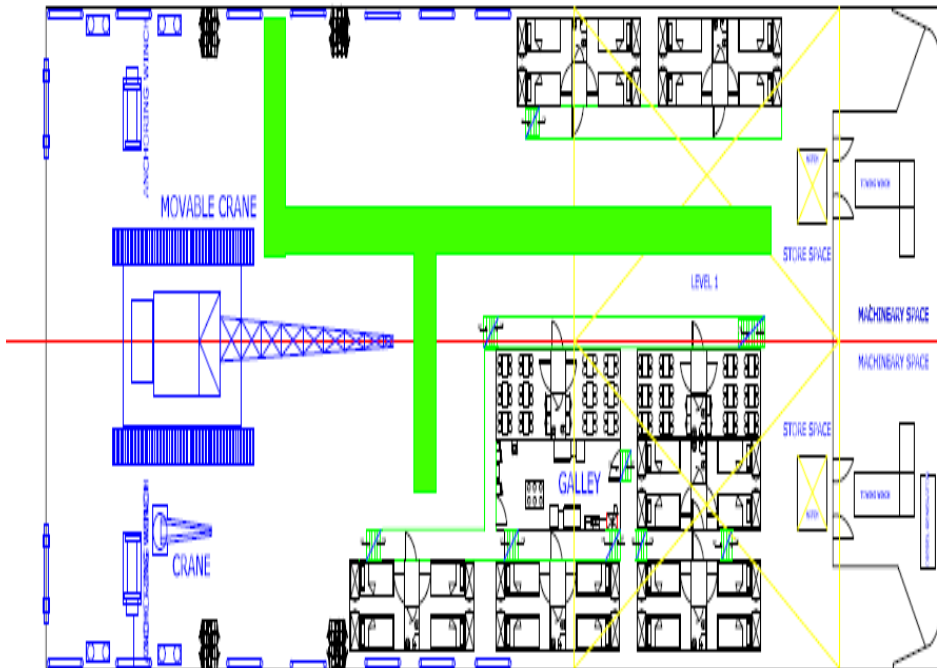
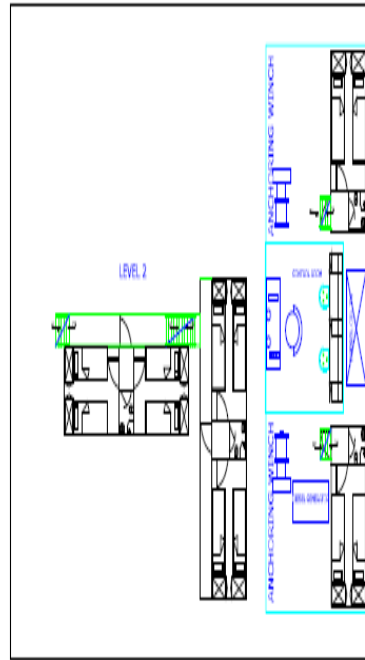

Ships & Boats Oil Service Company
Fire control & life saving plan
Barge Name : Sea Bulk Plover
Length O.A 70.12
Breadth MLD 18.29
Depth MLD 4.26

SEA BULK PLOVER

Head Office: 23 Fawzy Moaz St., Horia Mall Floor 12, Alexandria, Egypt
 Tel. / Fax: + (203) 4281085-9575180 E-Mail: info@Ships-boats.com
 Branch Office: 27 North Chouefat Str., El-Tagamoa El-Khames. -New Cairo City, Egypt.
 Tel: +(202) 261 755 70 Fax: +(202) 261 755 40 Mob :+(20100) 6933200
 E-Mail: gomaa@ships-boats.com www.Ships-boats.com

